

# REVELATION

by UTTERMOST

R22130

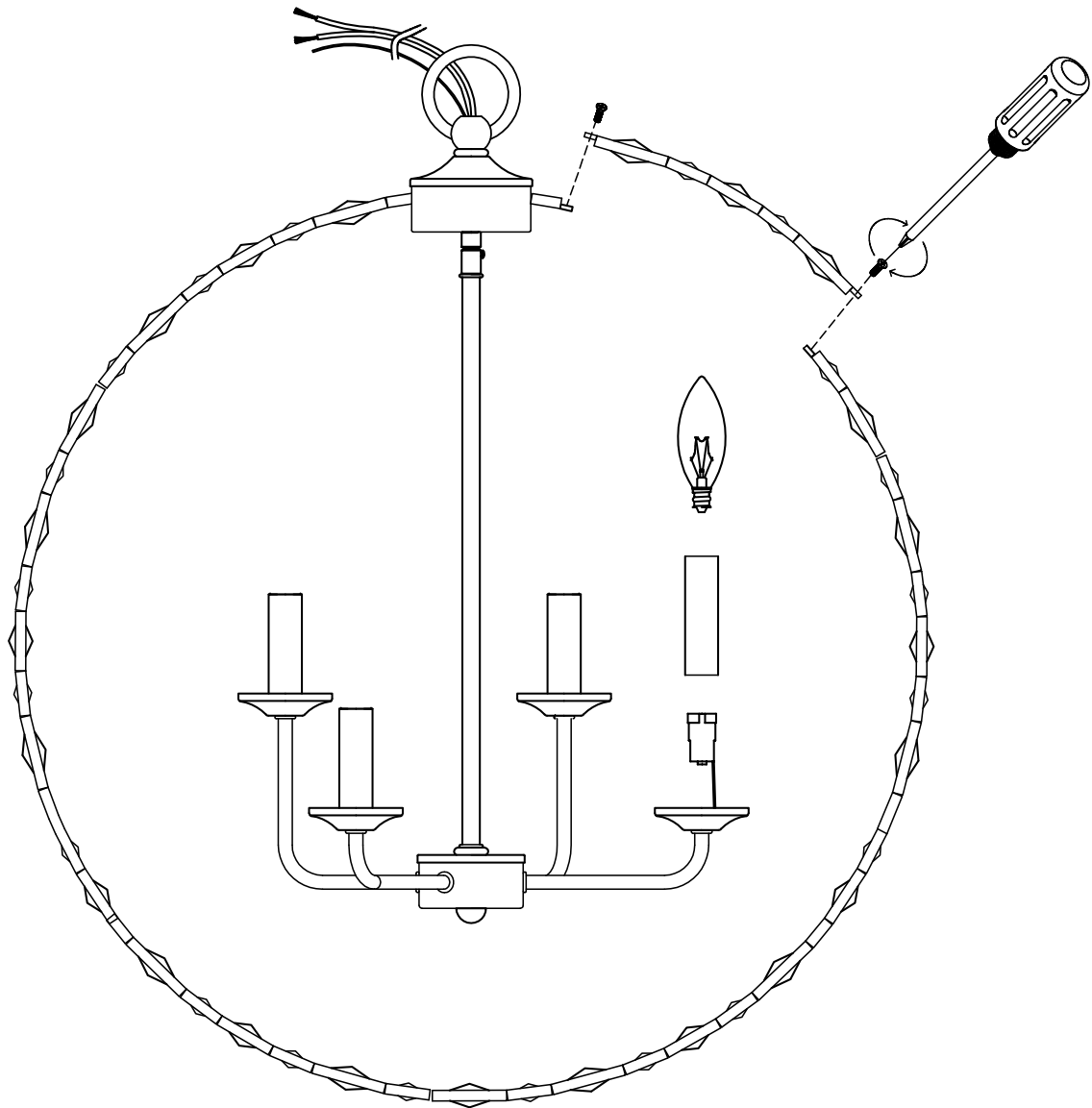

## ASSEMBLY INSTRUCTIONS

1. Connecting the wires refer the next page.
2. Install candle covers and light bulbs (not exceeding the maximum wattage) as shown on figure above, then replace access panel on crystal sphere.

# REVELATION

by UTTERMOST

**NOTE: ALWAYS TURN POWER OFF BEFORE INSTALLING LIGHTING FIXTURES!**

**IMPORTANT: YOU SHOULD USE A QUALIFIED ELECTRICIAN TO INSTALL THIS FIXTURE.**

## Installation (see Fig.A)

1. Disconnect power at main electrical panel before installation.
2. Attach **mounting strap** to **outlet box** using **box screws** provided with **outlet box**.
3. Screw threaded nipple into collar loop as far as it will go. Secure with lock washer and hexnut.
4. Screw threaded nipple into mounting strap approximately 1/2 inch. Adjust height of collar loop by temporarily holding canopy in place against ceiling with collar loop extending downward through hole in canopy.
5. Adjust chain & wire length as needed for your ceiling height, remove excess if needed, leaving enough for wiring connections. Use quick link on one end of chain and attach to loop on fixture. Thread fixture wire through chain links weaving wire through every second link.
6. Pull ends of chain and wires through collar ring and canopy.
7. Use second quick link and attach to collar loop.
8. Pass ends of fixture wires through center hole of collar loop, threaded nipple, and mounting strap.

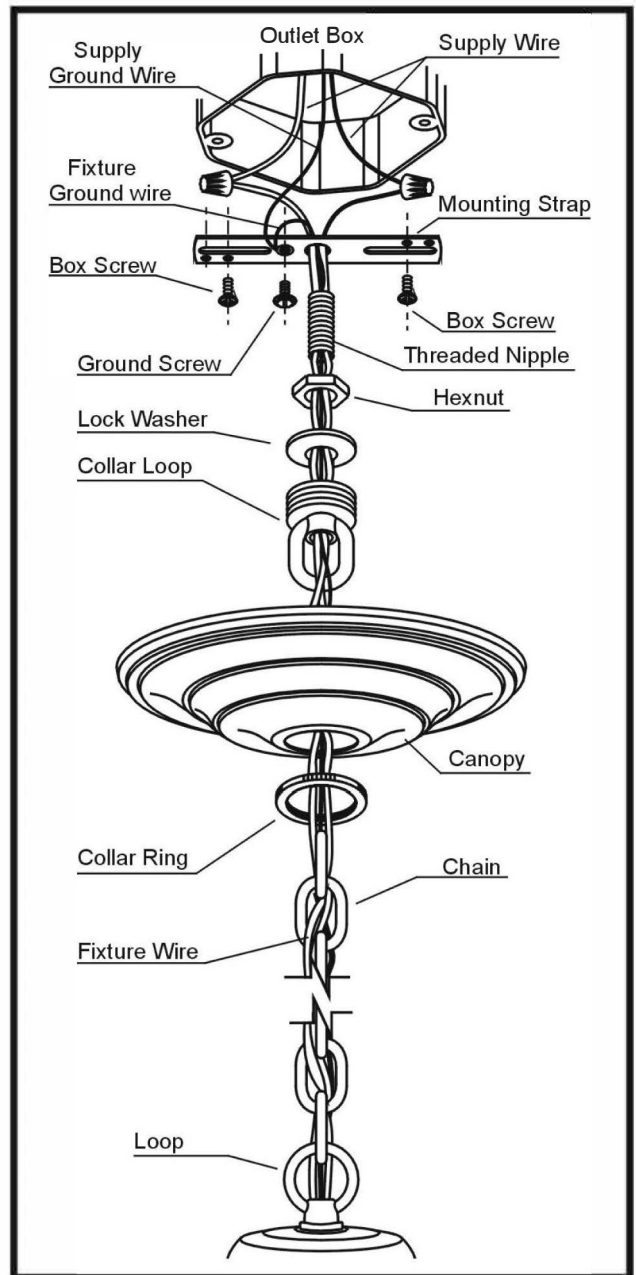

Fig. A

## Wiring (see Fig.B)

9. Split the conductors of the **fixture wire** about 4 inches. Being careful not to expose any of the wire inside of the insulation.
10. Connect the **fixture ground wire** and the **outlet box ground wire** to **mounting strap** with **GREEN** hex-head **ground screw** to tapped hole in **mounting strap** marked "GND".
11. Connect the half of the **fixture wire** that is white, marked, or has a ribbed surface to the **outlet box supply wire** (WHITE). Connect the other half of the **fixture wire** that is black, unmarked, or has a smooth surface to the **outlet box supply wire** (BLACK or RED). Use **wirenuts** provided.
12. Spread the electrical splices so that the black wire are on one side of the **outlet box** and the white wire are on the other side.
13. Slide **canopy** up into place against ceiling. Slide **collar ring** up and thread onto **collar loop** to secure **canopy** in place.

NOTE: Make sure chain supports the weight of the light fixture and no weight is on either supply or ground wires.

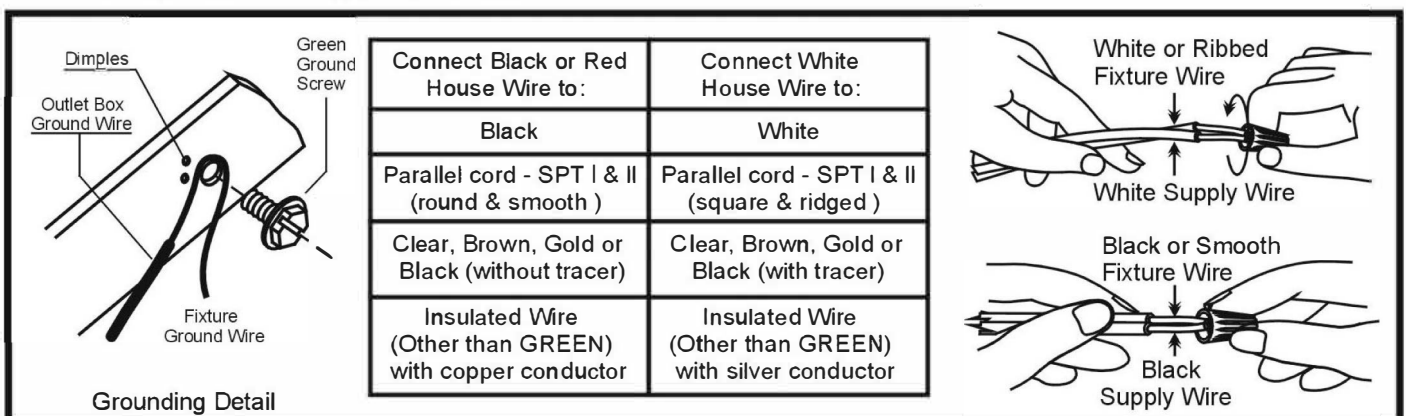

Fig. B

PO BOX 558/3325 GRASSY HILL RD. ROCKY MOUNT, VIRGINIA 24151

www.revelationbyuttermost.com