

REVELATION

by UTTERMOST

ASSEMBLY INSTRUCTIONS

STYLE NO. : R21342

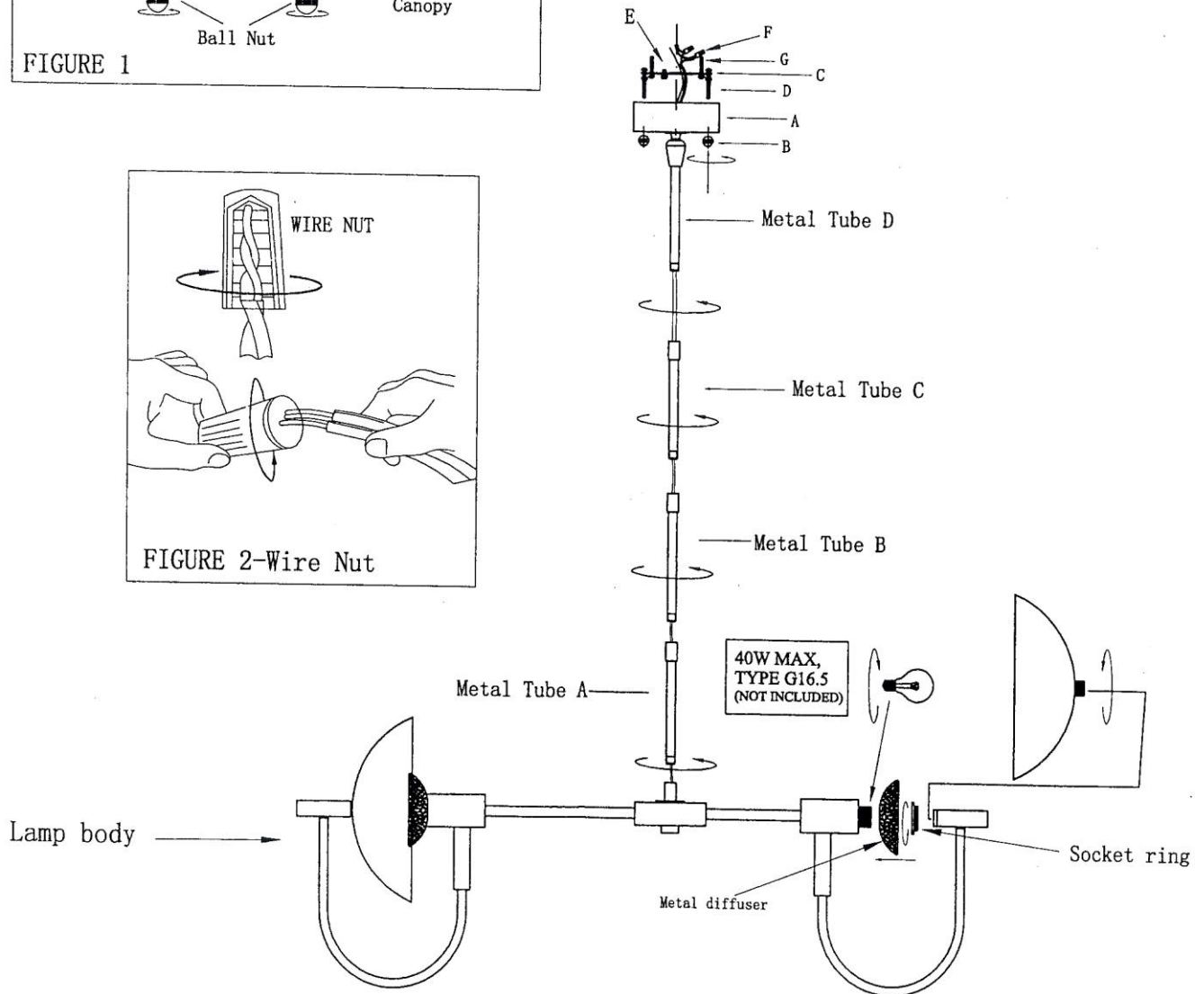
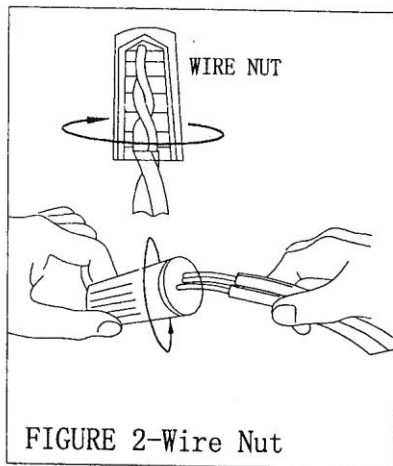
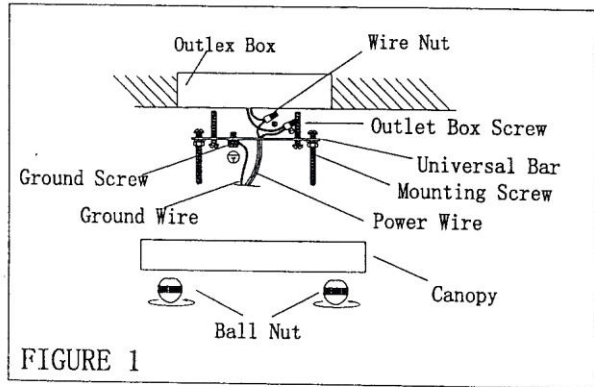

REVELATION

by UTTERMOST

ASSEMBLY INSTRUCTIONS

STYLE NO. :R21342 Parts and Hardware List

A.	Ceiling Assembly	1PC
B.	Ball Nut	2PCS
C.	Universal Bar	1PC
D.	Mounting Screw	2PCS
E.	Green Ground Screw	1PC
F.	Wire Nut	3PCS
G.	Outlet Box Screw	2PCS

Please make sure that you have all the parts indicated before you begin assembling this item.

Please read Wiring Instructions before you begin assembling and installing your Ceiling Lamp.

WARNING: BEFORE INSTALLING, make sure the electricity supply is shut off to avoid a possible electric shock.

Assembly Instruction

1. Take the parts carefully out of the carton, place them on a flat surface, and make sure that the parts will not be damaged.
2. Remove the Ball Nuts(B) under the Canopy from the Mounting Screws(D), and take out the Universal Bar(C). Attach the Universal Bar(C) to the Outlet Box by using two Outlet Box Screws(G). (See Figure1)
3. Adjust the length of the wire needed for your installation, remove excess, determine the number of Rods to be assembled to the Fixture Body as needed for your hanging height, then screw the Lamp body onto the Metal Tube A until tight.
4. Repeat the Step 3 with the Metal Tube B, C and D as needed for your installation height.
5. Install the ground wire in the Universal Bar(C) with the supplied Green Ground Screw(E).
6. Place the null wire, ribbed wire evenly against the ribbed wire from the Outlet Box and place the live wire, smooth wire evenly against the smooth wire from the Outlet Box. (Connecting the Wires-See Figure 2)
7. After the wires are connected, tuck them carefully inside the Outlet Box. attach the Ceiling Assembly(A) to the Mounting Screws(D) and secure with two Ball Nuts(B). (See Figure1)
8. Take off socket ring from socket firstly, and then put the metal diffuser on socket use the Socket ring to secure by turning in a clockwise direction.
9. Install the 8*40 Watt, Type G16.5 bulbs into the lamp holder of the fixture.
10. Screw the Glass shade onto the lamp body carefully until tightly.