

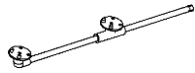

UTTERMOST

ASSEMBLY INTRUCTION ON ITEM #25414



① Metal Post (top)
= 2pcs

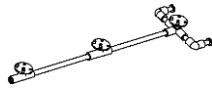

② Metal Post (bottom)
= 2pcs

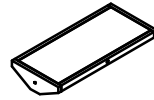

③ Top Shelf (with hole)
= 1pc

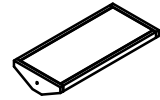

④ Bottom Shelf
= 4pcs



Ⓐ Flat Head Machine Screw
Ø¼"x19mm=4 pcs



Ⓑ Flat Head Machine Screw
Ø⅝"x1½"=10 pcs



Ⓒ Lock Washer
Ø14x⅝"x2mm=10 pcs



Ⓓ Flat Washer
Ø19x⅝"x2mm=10 pcs



Ⓔ Allen Wrench
Ø4=1 pc

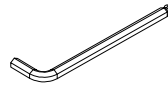

Ⓕ Allen Wrench
Ø5=1 pc

1

Ⓔ = 1 pc
Ⓐ = 4 pcs

2

Ⓕ = 1 pc
Ⓑ = 5 pcs
Ⓒ = 5 pcs
Ⓓ = 5 pcs

3

Ⓕ = 1 pc
Ⓑ = 5 pcs
Ⓒ = 5 pcs
Ⓓ = 5 pcs

4

Assembly is completed