

UTTERMOST

ASSEMBLY INSTRUCTIONS

23871

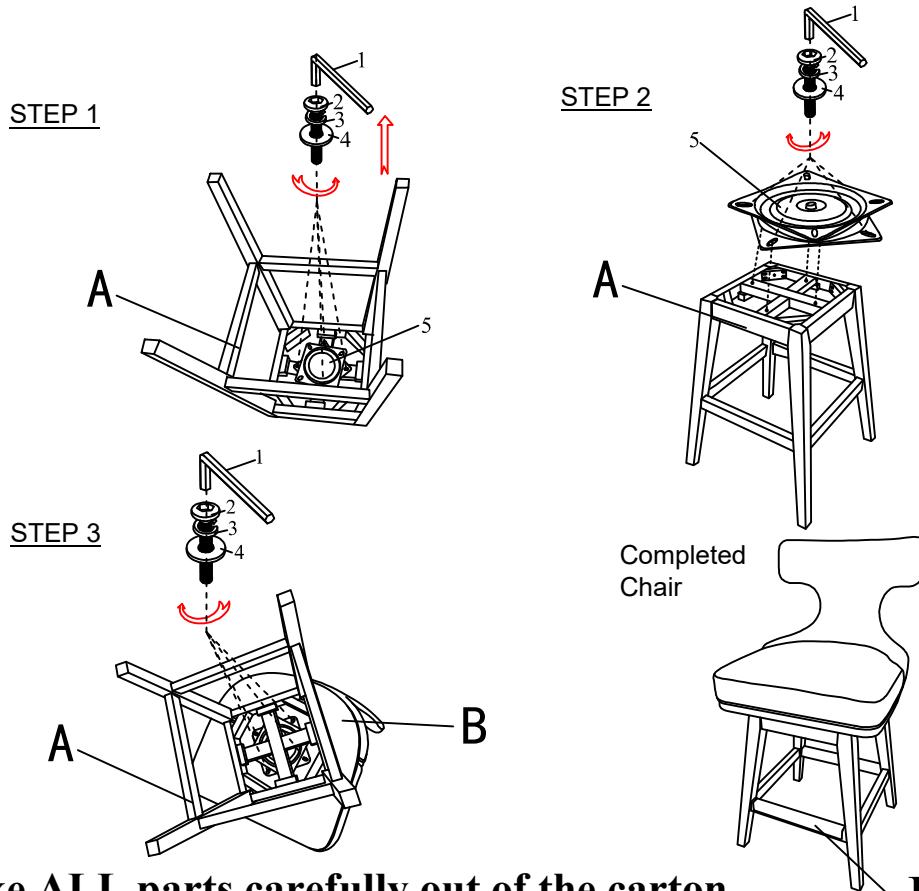

Take ALL parts carefully out of the carton and place on a flat surface. Be sure that no parts are damaged or missing before assembling.

STEP 1: Using the provided L Wrench, remove the Swivel Turnplate (5) from the underside of the Wooden Frame (A).

STEP 2: Reattach the turnplate on top of the wooden frame. Manually align the turnplate as shown in the diagram above before attaching the Seat Cushion (B).

STEP 3: Align the turnplate with the holes in the Seat Cushion (B) and secure to the frame with hardware as shown in the diagram above.

NOTE: The foot pin of front legs can be adjustable.

To clean, wipe with soft, dry cloth.

Hardware

1		"L" Wrench	1pc
2		Bolt 6*25mm	8pcs
3		Spring Washer	8pcs
4		Flat Washer	8pcs
5		Turnplate 6.75 inch	1pc